

LightCHAIR, III



CE



Find this notice at:
www.logo-silver.fr

LIGHT, EFFICIENT AND PRACTICAL
TO STORE OR TO TRANSPORT.

LOGO SILVER
EUROPE

CONTENTS

I.	INTRODUCTION	4
I.1	USAGE IN ACCORDANCE WITH THE INSTRUCTIONS.....	4
I.2	LIABILITY	5
I.3	INDICATIONS FOR REUSE.....	5
I.4	MAINTENANCE	5
II.	SECURITY	5
2.1	STANDARDS AND GUIDELINES.....	6
2.2	DECLARATION OF CONFORMITY.....	6
2.3	GENERAL SAFETY INSTRUCTIONS	7
2.4	TRANSPORT AND STORAGE SAFETY REQUIREMENTS	7
2.5	OPERATING SAFETY REQUIREMENTS.....	8
2.6	SAFETY REQUIREMENTS FOR MAINTENANCE, UPKEEP AND DISPOSAL.....	9
2.7	USER REQUIREMENTS	9
2.8	SECURITY FUNCTIONS	10
2.9	WARNING SIGNS AND SIGNALS	10
2.10	ELECTROMAGNETIC INTERFERENCE.....	10
III.	STRUCTURE AND PERFORMANCE	11
3.1	ELECTRICAL DIAGRAM FOR THE LIGHTCHAIR III	11
3.2	STRUCTURE OF THE LIGHTCHAIR III.....	12
IV.	SPECIFICATIONS	13
V.	INSTALLING AND FOLDING	14
5.1	INSTALLATION.....	14
5.2	FOLDING.....	15

VI. USAGE AND FUNCTIONALITY	15
6.1 USAGE	15
6.1.1 CONTROLLER	15
6.1.2 BATTERY USAGE	16
6.1.3 CHARGING THE BATTERIES.....	17
6.1.4 SURGE PROTECTION	17
6.1.5 BRAKE LEVER.....	17
6.1.6 SEATBELT	18
6.2 FUNCTIONALITY	18
6.2.1 PREPARATION BEFORE USE	18
6.2.2 TRAINING BEFORE USE	18
VII. DIAGNOSIS AND TROUBLE-SHOOTING.....	20
VIII. SAFETY DEVICES AND ACCIDENT MANAGEMENT	20
IX. UPKEEP	21
9.1 HUMIDITY	21
9.2 TEMPERATURE.....	21
9.3 GENERAL INSTRUCTIONS	21
9.4 UPKEEP AFTER USE	22
9.5 REGULAR CHECKS	22
9.6 CLEANING.....	23
X. TRANSPORT AND STORAGE	24
XI. OPENING AND VERIFICATION	24
XII. GUARANTEE	25
XIII. DISPOSAL	26

I. INTRODUCTION

These operating instructions provide the user, and those accompanying them, all the necessary knowledge about the construction and maintenance of the Lightchair III.

This user's guide contains information necessary for the safe use of this electric wheelchair and provides indications allowing to find possible causes of malfunctions and how to eliminate them.

It is imperative to read the contents of this user's guide in order to use the LIGHTCHAIR III in complete safety. The user, and those accompanying the user must attentively read this user manual, particularly the chapter on security, before the first usage. This allows full use of the LIGHTCHAIR III's capacities.

Pictograms and terms used as warnings:



DANGER!

Warning against physical danger and possible death



WARNING!

Warning against possible material damage



NOTE

Important information and advice



ENVIRONMENTAL NOTE

Information for the protection of the environment

I.1 USAGE IN ACCORDANCE WITH THE INSTRUCTIONS

The LIGHTCHAIR III is designed for the individual use of people presenting with a total or partial motor disability of the lower limbs, allowing autonomous movement at home or outdoors on smooth surfaces.

Do not use the LIGHTCHAIR III on terrain with obstacles, mud or snow, on grass, shingle or in the rain.

The LIGHTCHAIR III should only be combined with the options mentioned in this user's manual and vice versa. The company Logo Silver, manufacturer of LIGHTCHAIR III, is not liable in the event of association with medical devices and / or accessories not included in the options list or from other manufacturers.

Any use other than that which is mentioned is considered to be non-compliant. The responsibility for damage to people or to property resulting from non-compliant use is the responsibility of the user, not the manufacturer.

Only duly informed people are authorised to use the LIGHTCHAIR III. To be informed about the use of Lightchair III constitutes one of the conditions which protects people from possible dangers and the correct and safe use of the LIGHTCHAIR III.

I.2 LIABILITY

The manufacturer may only be held liable if the instructions for use, maintenance and servicing intervals of the Lightchair III are respected. The manufacturer expressly states that only spare parts authorised by the manufacturer may be used. Logo Silver company declines all responsibility for damage resulting from the use of spare parts not authorized by the manufacturer as well as damage resulting from use not in accordance with the instructions. This warranty is subject to French civil and commercial law.

I.3 INDICATIONS FOR REUSE

The LIGHTCHAIR III has been designed to be reused.

Like used machines or vehicles, reused products are subject to specific constraints. The modification of characteristics and performances must not compromise the safety of people for the duration of the product.

Due to market observations and state of the art technical characteristics, the manufacturer has evaluated between 6 and 7 years for the duration of use of the LIGHTCHAIR III, provided that it is used in accordance with the instructions and that the care and maintenance instructions are followed. This duration does not take into account the storage times with the manufacturer or with the distributor. It should be noted that if the LIGHTCHAIR III is maintained in accordance with instructions, it remains reliable beyond the period defined above.

To be reused, the LIGHTCHAIR III must be thoroughly cleaned beforehand. Then, the condition, wear and damage of the LIGHTCHAIR III must be checked by an approved specialist. All worn or damaged parts as well as non-fitting components, or those not suitable for the new user should be replaced.

The maintenance manual contains a calendar of the maintenance operations to be carried out for each model as well as detailed information and the list of tools required.

I.4 MAINTENANCE

If you have questions or have a problem that you cannot resolve despite the assistance provided by the operating instructions, please contact your dealer.



NOTE

LIGHTCHAIR III checks and repairs must be carried out exclusively by qualified personnel approved by the Silver Logo company. In the event of any problem, please contact the specialist dealer which sold you the product.

II. SECURITY

2.1 STANDARDS AND GUIDELINES

All the safety information in this manual relates to the french legislation in force and the provisions of the European Union. In other countries, it is necessary to respect the corresponding legislations and provisions.

The LIGHTCHAIR III was manufactured in accordance with current technical regulations for safe operation. The safety of the LIGHTCHAIR III is certified by CE and its declaration of conformity.

2.2 DECLARATION OF CONFORMITY

As the manufacturer, Logo Silver declares under its own responsibility that the LIGHTCHAIR III complies with specifications 93/42 and 2007/47 relating to European directives for medical devices.

The design, development and manufacturing of the LIGHTCHAIR III are fully compliant in terms of safety, by the following technical requirements:

- Risk analysis and management according to NF EN ISO 14971 standards
- Design requirements NF EN 12182 and NF EN 12184
- Dynamic stability, static stability, fatigue resistance test
- Product information: NF EN 12182 and NF EN 12184
- Advertising documentation, use and maintenance guide, labeling, defining of energy consumption, determination of speed, acceleration and deceleration, ability to climb the maximum slope safely, ability to mount obstacles.
- Compliance with standards NF EN 12184 means, among other things, that the required values for an inclination, the crossing of an obstacle, a speed, are reached or even exceeded by the LIGHTCHAIR III.

2.3 GENERAL SAFETY INSTRUCTIONS

- The LIGHTCHAIR III may only be used in conformity with the instructions.
- Only duly informed and authorized people may use the LIGHTCHAIR III
- Only one person may use the LIGHTCHAIR III at any given time.
- Other safety elements, belt and vest can be ordered as accessories from Logo Silver.
- All safety instructions contained in this user manual and in all valid associated documents must be observed and applied. This notice must be available to the user at all times.
- The fabric of the backrest and the cushion may, however unlikely, catch fire. The use of fire or a lit cigarette must be undertaken with extreme care.
- Beware of obstacle clearance when driving uphill and descending.
- Power level changes must be made while stationary.
- Make sure the joystick is securely attached and straight.
- Make sure the motor levers are unlocked in the «electric» position.
- Only original manufacturer options can be used. The optional components must be fitted exclusively as indicated below. Failure to respect this recommendation results in the loss of warranty.
- After removing special screws, nuts or washers; replace them if damaged and tighten them firmly.

2.4 TRANSPORT AND STORAGE SAFETY REQUIREMENTS

- The LIGHTCHAIR III is designed to be folded, and must be transported in this fashion, or in a transport case (sold as an optional extra by Logo Silver) in order to travel safely. The LIGHTCHAIR III must only be lifted by the elements of the chassis.
- During transport, the electrical part of the LIGHTCHAIR III must be switched off via the disconnected «On / Off» button.
- It is forbidden to travel seated in the LIGHTCHAIR III when transporting it.
- In order to guarantee the LIGHTCHAIR III's lifespan, it must be stored in a sheltered place.
- After each setting adjustment or modification made on the LIGHTCHAIR III, the mounting screws and nuts must be tightened securely.

2.5 OPERATING SAFETY REQUIREMENTS

- Before each use, the user must ensure that the LIGHTCHAIR III is in a safe condition and in accordance with the instructions, including the security functions.
- The operating and safety condition of the LIGHTCHAIR III must be checked at least once a year by an approved specialist.
- If errors, faults or other hazards are detected which might cause personal injury, the LIGHTCHAIR III must be taken out of service immediately.
- The LIGHTCHAIR III works only at temperatures between -10 ° C and+ 35 ° C. During operation, the LIGHTCHAIR III must not be exposed to temperatures outside the range of those indicated above.
- The maximum load supported by the LIGHTCHAIR III is 150 Kg. This weight must not be exceeded
- Before each use, a visual check must be carried out to verify that the tyre pressure is correct (see tyre inscriptions).
- When traveling on public roads, you must respect the road code.
- The controller should be 'off' when making transfers.
- Small obstacles must be crossed at a moderate pace (3 km / h) and preferably in a perpendicular fashion.
- Maneuvers may only be carried out at reduced speed.
- LIGHTCHAIR III may generate electromagnetic interference which may disrupt the proper functioning of other devices. It is therefore better to turn it off while not in use
- In regard to tyres, please note the following:
 - - The tyres of the LIGHTCHAIR III contain chemical substances which may react with other chemicals (e.g. cleaning chemicals or acid).
 - - Direct exposure to sunlight (UV) accelerates tyre aging. This results in a hardening of the side of the tyre which cracks on the edges.
 - - Regardless of their wear, the tyres must be changed every 2 years.
 - - Prolonged non-use or significant heat on the tyres (if the LIGHTCHAIR III is near a heater or exposed to direct sunlight through a window) they may deform permanently . Ensure, therefore, to maintain a sufficient distance from heat sources.
- The LIGHTCHAIR III can be driven on inclinations and descents of 9°, you must not attempt steeper ascents or descents.
- While driving downhill, for security reasons, speed should be reduced.
- Charging the batteries can produce explosive gases. Which is why it is necessary to take the following safety measures while charging:
 - Switch off the LIGHTCHAIR III
 - Ensure the room is ventilated
 - It is forbidden to smoke or to start a fire. It is imperative to avoid sparks.

2.6 SAFETY REQUIREMENTS FOR MAINTENANCE, UPKEEP AND DISPOSAL

- LIGHTCHAIR III maintenance must be carried out by qualified personnel, approved by Logo Silver. This also applies to all repairs and settings.
- The On / Off button must be switched off and the batteries removed for all maintenance.
- The LIGHTCHAIR III may be cleaned with a wet sponge (avoid detergents).
- Defective batteries must be returned to distributors or Logo Silver in order to be recycled in accordance with environmental specifications.

2.7 USER REQUIREMENTS

- The use of LIGHTCHAIR III is reserved for capable users. Which is why the user must be instructed by qualified personnel, approved by Logo Silver in order to drive the LIGHTCHAIR III.
- The user must have read and understood this user manual completely.
- It is forbidden to use the LIGHTCHAIR III in case of significant fatigue, or under the influence of alcohol or medicine.
- Before the first usage, practice driving the LIGHTCHAIR III on level ground and with good visibility, then increase the difficulties, by crossing small obstacles, descents and climbs. This training helps avoid dangerous situations.



DANGER!

If your wheelchair moves involuntarily, release the joystick immediately and the chair will stop automatically. In the event of a joystick or brake malfunction, turn off the power-supply.

2.8 SECURITY FUNCTIONS

In case of danger, the LIGHTCHAIR III can be switched off at any time with the On / Off button. The charger will automatically shut off as soon as the batteries are charged.

2.9 WARNING SIGNS AND SIGNALS

LOGO SILVER
EUROPE

163 cours Berriat
38000 Grenoble / France

REF: LIGHTCHAIR III
SN:000000 I

02/2021

CE MD ⓘ 150 kg max. 9° max.

- Reference
- Serial number
- Fabrication date
- CE approval
- Medical device
- Read the instructions before use
- Maximum slope
- Maximum user weight

2.10 ELECTROMAGNETIC INTERFERENCE

Your wheelchair can travel in areas affected by electromagnetic interference electromagnetic or signals from certain transmitters such as radio, wireless intercoms, cell phones, speed cameras, etc. In which case, your driving may be disrupted. Electromagnetic interference can modify the electric wheelchair's control system. Certain disturbances may cause brake-failure, involuntary movements, as well as irreversible damage to the control system.

Electromagnetic interference classification

- Short-band radio transceiver. Such as radio waves in urban areas, walkie-talkies, mobile telephone networks and signal transmissions of communication devices.
- Medium-band mobile radio transceiver. These are usually installed in a building or vehicle. For example: police, fire department, taxi, ambulance and other radio transceivers.
- Broadband radio transceiver. These are usually installed in a tower, such as commercial radio or TV transmission systems.



WARNING!

The wheelchair and battery charger comply with the following code standards: GB / T 18029.21 Wheelchair - Part 21: Requirements and test methods for electromagnetic compatibility.



WARNING!

Electromagnetic interference (EMI) can affect the driving of the chair. This interference can come from mobile phones, radio transmitters, TV...

Preventing electromagnetic interferences

- Do not use portable radio transceivers such as cell phones, radios, etc. when the wheelchair is on.
- Avoid driving near radio transmission systems such as radio and television transmitters.
- If the electric wheelchair or its brakes are faulty, please contact your company or reseller.

III. STRUCTURE AND PERFORMANCE

3.1 ELECTRICAL DIAGRAM FOR THE LIGHTCHAIR III

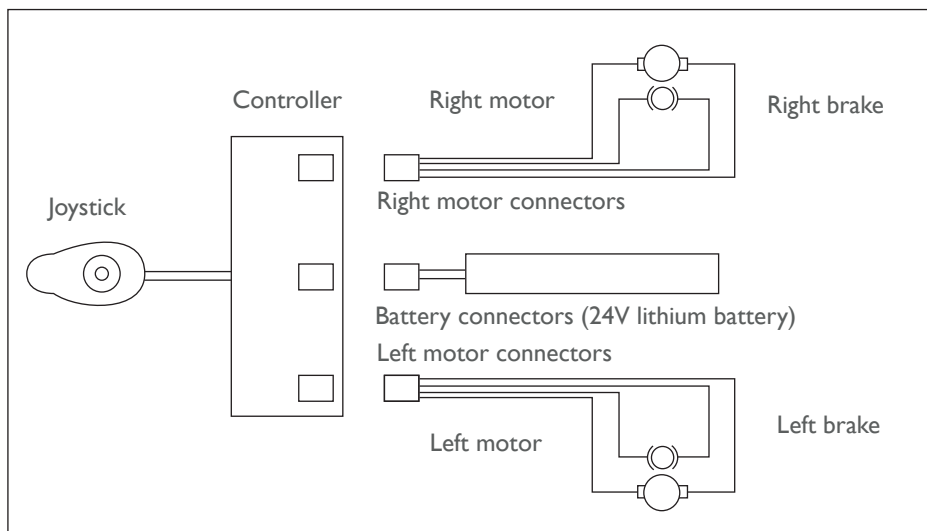

3.2 STRUCTURE OF THE LIGHTCHAIR III

The LIGHTCHAIR III is composed of the following main parts: the front and rear wheels, the chair frame, joystick, motor, armrests, handlebar, backrest, seat, footrest, battery box and charger. See fig. 1



IV. SPECIFICATIONS

The principal specifications including the dimensions and weight.

General dimensions	100 cm x 63 cm x 96 cm
Dimensions when folded	77 cm x 63 cm x 37 cm
Seat height	550 mm
2 seat widths	40 cm and 45 cm
Seat depth	45 cm
Armrest height	19 cm
Backrest height	42 cm
Wheelchair weight	32 kg
Maximum speed	6 km/h
Turning radius	100 cm
Maximum user weight	150 kg
Autonomy	20 km
Static stability	9°
Dynamic stability	6°
Maximum slope gradient	9°
Mounting capacity	4 cm
Motor type	24 V / 250 W
Lithium battery type	2 x 24V 10 Ah
Maximum controller output current	35 A
Max. Charger output current	2 A
Front wheel	200 mm O.D solid tyre
Rear wheel	300 mm O.D solid tyre

V. INSTALLING AND FOLDING

5.1 INSTALLATION

- Take the wheelchair out of the box and put it on the floor. Install the batteries by inserting them into the housing (fig. 3), remove the remote control (fig. 2). Remote control operation: press buttons A and C, then B to fold or D to unfold the wheelchair.
- Place the joystick on the armrest (fig 4) and lower the tightening key onto the controller to attach it (fig. 5).
- To remove the battery (fig. 7): hold the “A” then pull the “B”.
- Put the engine lock lever in «electric» mode to ensure the wheelchair is not in manual mode. (fig. 6)
- Press the backrest adjustment button with two fingers to move the backrest forwards or backwards (fig. 8).

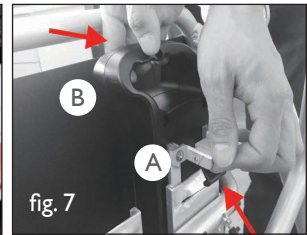
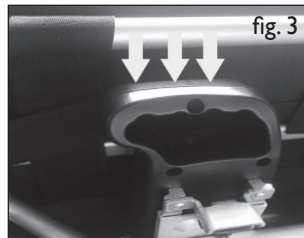
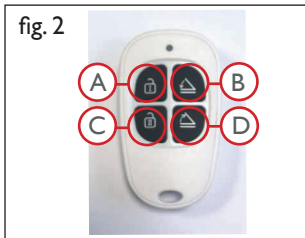

5.2 FOLDING

The LIGHTCHAIR III can be folded up for storage or transport.

Before folding, with the on/off switch or the remote control, remove the seat cushion and unfold the entire pallet.

- Operation with the on/off switch:
Make sure the switch is on '0', which means it is 'powered off,' '1' means that it is «running», «-» means «unfold», «=» means «fold». (fig. 9)
- Remote control operation:
Press buttons A and C, then B to fold and D to unfold the chair. (fig. 2)



DANGER!

Do not fold the chair when someone is sitting in it: risk of serious injury.

VI. USAGE AND FUNCTIONALITY

6.1 USAGE

6.1.1 Controller

This is the key element of a wheelchair.
It allows the control of all electronic functions (fig. 12). The controller is usually installed on an armrest and connected to a motor and a battery in its housing.

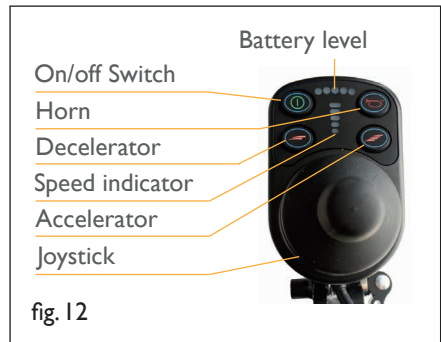

fig. 12

- On/off switch: the switch powers the electronic function control system and wheelchair motors. Do not use the switch to stop the chair except in an emergency. Otherwise, it may shorten the life of the chair components and cause violent braking.

- Joystick: the joystick is used to control the movements of the wheelchair, including its speed and direction (forwards, backwards, left or right, etc.). The more you push the joystick forward from its central position, the more quickly the wheelchair moves. Each time you release the joystick, it automatically returns to the center and the brake automatically stops the wheelchair.
- Horn: the horn sounds if you press this button.
- Acceleration / deceleration buttons and speedometer: after turning on the wheelchair the speedometer indicates the current maximum speed setting. This can be adjusted by the user by using the same button.
- Charger socket: the socket should only be used for this wheelchair. Do not use the plug to power other electrical devices. Otherwise, it could damage the chair's control system or its E.M.C performance (electromagnetic tolerance).



NOTE

If your wheelchair accidentally moves, immediately release the joystick and the chair will stop automatically.



WARNING!

If you connect devices to the outlet other than the supplied battery charger, damaging the control system, the warranty will be canceled.

6.1.2 Battery usage

Fully charge the battery before the first use. This brings the battery to approximately 90% of its capacity.

Upon the second battery charge (8-14 hours) they will obtain more than 90% of their capacity. After four or five charge charge-cycles, the batteries will recharge to 100% and will last longer. Please replace the batteries in case of failure. The old batteries must be returned to the supplier to avoid unnecessary pollution of the environment.

Battery specification	
Type	Lithium battery
Dimensions	330mmx105mmx65 mm
Power	24V
Amp hour	2x10Ah



fig. 10

**WARNING!**

Do not use your wheelchair when the temperature is below -10°C or above 50°C .

**WARNING!**

The 24V / 2A charger supplied by the manufacturer meets the requirements mentioned in Section I “General safety requirements” of GB9706.1- 2007 electric medical equipment. The battery must be charged with the charger supplied. Any other type of charger is not allowed.

**DANGER!**

Never let the battery freeze, do not charge a freezing battery, this could cause injury and damage the battery.

6.1.3 Charging the batteries

The battery charger is an important part of the wheelchair. The external charger connected to this product allows to charge the battery quickly and to easily optimize the use of your wheelchair.

Charging the battery using the provided external charger:

- Make sure the joystick is turned off and the wheelchair is in driving mode.
- Connect the 3-pin charger output plug to the joystick. (Fig.10)
- Connect the charger’s power plug to a standard wall outlet.
- The orange LED on the charger indicates that charging is in progress. The green LED on the charger turns on when the battery is fully charged.
- We recommend charging the battery for 8 to 12 hours
- Remove the charger and power plug when the battery is fully charged and store them in the bag behind the backrest.

6.1.4 Surge protection

The fuse, located at the back of the wheelchair, is designed for the safety of the wheelchair user. When there is a surcharge, the fuse cuts the current. If the fuse is tripped, replace it with an identical 12-24V 30A model.

6.1.5 Brake lever

When you want to stop, release the joystick and it will stop immediately.

6.1.6 Seatbelt

For your safety, the seat belt must be fastened before driving the wheelchair. (fig. 11)

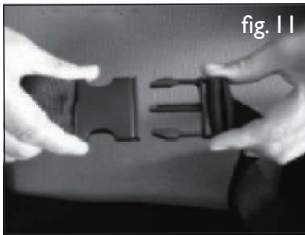

6.2 FUNCTIONALITY

6.2.1 Preparation before use

- Turn power off before any and all transfers
- Verify that the brakes function correctly
- Fold the footrest pallet then hold the armrest to sit in the wheelchair.
- Do not get out of the wheelchair by pressing on the footrest palate. Otherwise, the chair may tip over.

6.2.2 Training before use

- Find a spacious place like a public square and ask an assistant to help you practice until you have enough confidence to use the LIGHTCHAIR III alone.
- Press the power button on the joystick, the battery light will come on.
- Choose the lowest speed until you can use the wheelchair with confidence.
- Push the joystick forward, observe the movement of the wheelchair, then push it in all directions and observe the rotation of the wheels.
- Release the joystick and observe that the wheels stop turning.



WARNING!

Turn the power off when climbing in and out of the wheelchair.

- When you are capable, you can test S-turns. Once familiar with 'S' turns, you can reverse while paying attention to the speed setting. Reverse speed must be less than forward speed.

(fig. 13)

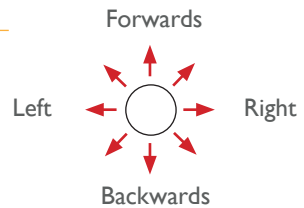
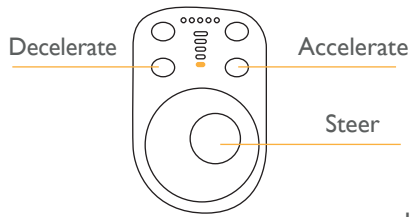
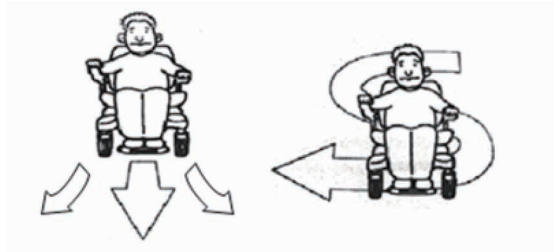

DANGER!

Do not use your wheelchair in manual mode except with the help of an assistant. Otherwise, it could cause injury.



DANGER!

Do not put your wheelchair in manual mode while it is on a slope. Otherwise, the wheelchair could descend the slope and cause injury.

VII. DIAGNOSIS & TROUBLE-SHOOTING

For your convenience, this product has an automatic fault warning system. In the event of a malfunction, the indicator lights on the controller flash and the horn sounds. You can identify a fault using the information in Table. If the problem persists after inspection of the fault, do not use the wheelchair. Turn it off and contact your dealer.

LED	Anomaly Diagnosis	Breakdown location
1 LED lit	Weak battery	Charge the battery
2 LEDs lit	Left motor anomaly	Check the motor and its connections
3 LEDs lit	Left brake anomaly	Check that the brake lever is in the correct position and if the braking is damaged.
4 LEDs lit	Right motor anomaly	Check the motor and its connections
5 LEDs lit	Right brake anomaly	Check that the brake lever is in the correct position and if the braking is damaged.
6 LEDs lit	Control box overload	Check if the brake is removed and if the wheels are locked
7 LEDs lit	Joystick anomaly	Check that the joystick is in the central position
8 LEDs lit	Control box anomaly	Control box malfunction
9 LEDs lit	Control box anomaly	Control box malfunction



WARNING!

In order to guarantee the quality of the electric wheelchair, please contact your dealer to replace the spare parts such as batteries, tyres, controller, motors and charger. Maintenance must be carried out by the dealer.

VIII. SAFETY DEVICES AND ACCIDENT MANAGEMENT

- Fuse: please refer to 6.1.4 Surge protection
- Safety belt: please refer to 6.1.6 Safety belt
- Release the joystick in case of failure: the wheelchair will stop.

IX. UPKEEP

Your electric wheelchair requires regular maintenance. Some checks can be carried out by yourself, others, by your dealer. Preventive maintenance is very important. If you follow the maintenance instructions in this section, your wheelchair will work for years without a problem. If you have any doubts about the upkeep or the operation of your wheelchair, please contact your dealer or our after sales service.

9.1 HUMIDITY

Your wheelchair, like most electrical and mechanical equipment, is sensitive to external conditions. Avoid humid environments. Direct or prolonged exposure to water or moisture as this could cause electronic and mechanical failure. Water can corrode the electrical components and the frame of the chair.

9.2 TEMPERATURE

In extremely cold weather, the battery may freeze. Unusual temperatures may cause many components such as the charger and battery (batteries sealed with lead-acid or gel batteries) to freeze. Temperatures above 55° C may slow your wheelchair.

9.3 GENERAL INSTRUCTIONS

- Avoid bumping the controller, especially the joystick.
- Avoid prolonged exposure of your wheelchair to extreme conditions, like hot, cold or humid environments.
- Keep the controller clean.
- Check all electrical connections, including cable and charger, and make sure they are all tightly secured.
- If only the red LEDs are lit on the battery meter, you must recharge the batteries as soon as possible, for 8 to 12 hours.



DANGER !

Never charge a cold or frozen battery, this may damage the battery and risks explosion.

- The surface of the wheelchair chassis has a protective coating. You can apply a light coat of car wax to maintain its shine.
- Check the cables. Make sure they are connected and that they are not corroded. The battery should be placed in the battery housing, flat, with the plug facing inwards.
- All wheel bearings are lubricated and sealed. There is no need to lubricate.
- Check for loose parts, such as the wheel axle, bearing and the chair itself. If they are loose, tighten securely.

9.4 UPKEEP AFTER USE

- Switch off your wheelchair and disconnect all connectors if it is not in use for a long time.
- Prohibit children and neglectful people from using the wheelchair.
- Store the chair at normal temperatures to prevent deformation and maintain its performance for a long time.
- Clean and dry the wheelchair with a clean, soft cloth. Never use chemicals to clean it (to prevent warping and discoloration).
- Remove the fabric cover from the seat for washing. Dry before use.

9.5 REGULAR CHECKS

In order to maintain the good condition of your wheelchair, you should check it before each use. To carry out the weekly, monthly and twice-yearly checks, see Table:

Parts and functions to inspect	Each use	Every week	Every month	Twice per year
All parts			•	
Joystick	•			
Braking system	•			
Connection		•		
Battery condition	•			
Tyre condition			•	
Chassis condition				•
Front wheel condition		•		
cleanliness	•			



NOTE

Only spare parts from Logo Silver may be used. Failure to comply with this condition results in loss of warranty. If you have any problems during maintenance, consult your dealer. The LIGHTCHAIR III must be checked once a year by qualified personnel approved by Logo Silver.

9.6 CLEANING

- The LIGHTCHAIR III must be cleaned regularly regardless of use or the degree of dirtiness.
- Never wash the wheelchair with water or expose it directly to water.
- The chassis surface has a protective coating. You must use a cloth moistened with soapy water to clean it, then dry completely.



WARNING!

Never use chemicals to clean the seat or armrests or you risk damaging the material or making it slippery.



WARNING!

Risk of damage to the electronic system! Risk of dysfunction !
When cleaning the LIGHTCHAIR III, water should never come into contact with electronic components and batteries.



WARNING!

Do not use aggressive cleaning agents, solvents or hard brushes.

X. TRANSPORT AND STORAGE

- The wheelchair may be transported folded or unfolded.
- Your wheelchair must be stored in a dry place, sheltered from extreme temperatures and humidity.
- Remove the batteries before storing it. Otherwise, the structure may rust and electrical components may be damaged.



DANGER!

When transporting the chair, folded or not, it is recommended to strap to the vehicle's tie-down rings.



DANGER!

The wheelchair must not be used as a seat in a vehicle.

XI. OPENING AND VERIFICATION

Upon reception, verify that the carton is complete and that there are no damaged parts.

Packing list :

N°	Name	Quantity	Note
1	Electric wheelchair	1	Model:W5517
2	Charger	1	Model: HP0060WL2/60 HZ 24V2A
3	User manual	1	
4	Controller	1	

XII. GUARANTEE

The wheelchair is guaranteed for a period of 2 years from the date of delivery, excluding; corrosion, worn parts (tyres ...), when used in compliance with the instructions. The batteries are guaranteed for 1 year.

- The warranty covers any construction or quality defect in the raw material or components, under normal conditions of use (except normal wear of parts).
- The warranty is limited to the free repair or exchange of parts and sub-assemblies recognized as defective (parts, labor and transport), after inspection by an authorized representative.
- Warranty repairs must be authorized and performed by an approved supplier. Do not return parts without obtaining prior authorization.

WARRANTY EXCLUDED

- Accidents or accidental impacts,
- Negligence,
- Abnormal usage,
- Inappropriate maintenance,
- Modifications carried out without the authorisation of the manufacturer,
- Use not in accordance with the instructions in the user guide supplied with the product or that does not meet product specifications,
- A removal or erasing of the serial number,
- Cold storage or batteries left completely discharged for a long time.

XIII. DISPOSAL

- Respect the provisions in force in your country for the protection of the environment.
- Batteries that are no longer used are taken back by your dealer or by Logo Silver.
- The LIGHTCHAIR III may be returned to Logo Silver for recycling.

163 cours Berriat - 38000 Grenoble - France
+33 (0)4 76 21 22 19
contact@logo-silver.fr
www.logo-silver.fr



ENVIRONMENTAL NOTE

To discard the LIGHTCHAIR II, remove all components and materials respecting the environment and in accordance with the waste sorting instructions in force.

Light**to**HAIR III

by

LOGO **SILVER**
EUROPE

Logo Silver Europe

163 cours Berriat - 38000 Grenoble - France
Tél. +33(0)4 76 21 22 19 - contact@logo-silver.fr

www.logo-silver.fr